

INSTALLATION INSTRUCTIONS

2018 Double Canopy / Enclosure

Tracker Marine Fishin Barge 20 Signature

PARTS LIST

Double Canopy
1 Bow Canopy
1 Bow Canopy Boot
1 Aft Canopy with Front Zipper
1 Hardware Package
1 Bow Frame

TOOLS REQUIRED

Measuring Tape
Center Punch
Drill
 $\frac{23}{64}$ " Drill Bit
Pencil
Phillips Screwdriver
Adjustable Wrench

**WARNING**

INDICATES POTENTIAL HAZARD
THAT COULD RESULT IN DEATH
OR INJURY

**CAUTION**

INDICATES POTENTIAL
HAZARD THAT COULD
RESULT IN BOAT DAMAGE

**NOTE**

INDICATES SPECIAL INFORMATION
TO MAKE MAINTENANCE EASIER
OR INSTRUCTIONS CLEARER



NOTE:

This enclosure is designed to fit the 2016-17 GTracker Marine Fishin Barge 20 Signature Pontoon Boat that has the aft canopy brackets in the following locations:

Main Aft Bracket 94.5" Rear Aft Button 21.5" Forward Aft Button 20.5"

Measurements should be taken from the back of fence for Aft Canopy Brackets and as shown below for bow canopy brackets and buttons in the following locations:

Main to Main 93.5" Main to Hold-down Arm 18"

If the brackets are off more than 1-inch in either direction, the enclosure WILL NOT FIT.

All measurements are taken to the center of the brackets.

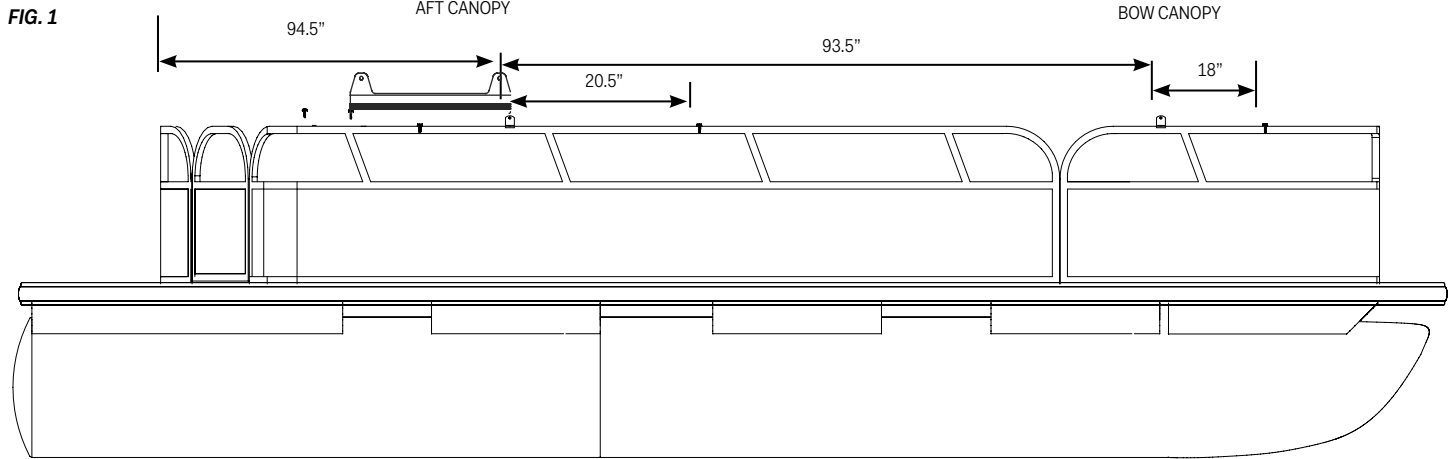

NOTE:

Your pontoon has been pre-assembled with an aft canopy and aft canopy frame from Tracker Marine. The aft canopy that is supplied with the pontoon is not designed to be used with an enclosure. You must remove the standard aft canopy and replace it with the aft canopy that is supplied with the purchase of your enclosure. Once the new canopy is installed, raise the entire unit to the "up" position. Make sure the aft canopy is centered on the frame between the port and starboard sides. This step is very critical, it will determine the final appearance of your completed enclosure.

BRACKET LOCATIONS & ASSEMBLY (FIGURES 1 & 2)

STEP 1

Bracket location (A). Measure and place a mark on the top rail 93.5" forward from aft main bracket. Button location (B). Measure and place a mark on the top rail 18" forward from (A).

STEP 2

Center the brackets at each mark as shown in Figure 2. Mark each hole for drilling.

STEP 3

Using 2 1/4" drill bit, drill holes completely through the top rail.

STEP 4

Replace the brackets. Insert (2) bolts from the bottom through the bracket and the rail. Place (2) lock nuts on and tighten (Figure 2).

STEP 5

Install deck buttons at location (B) using barrel nuts.

STEP 6

Follow the same procedure for the other side.

FIG. 2

NOTE:
SHOULDER WASHERS
MUST BE INSERTED ON
EACH SIDE BETWEEN
THE FRAME AND
BARREL NUTS.

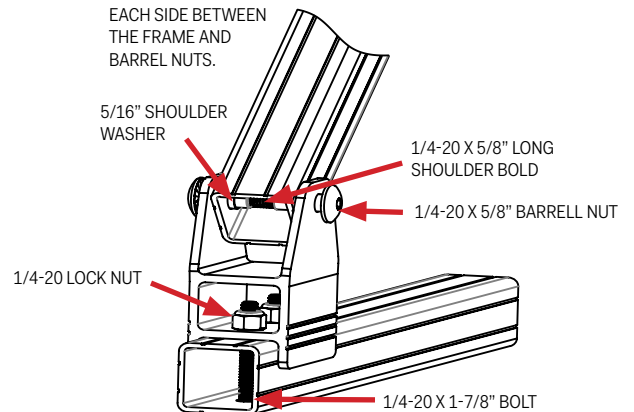

CAUTION

TO PREVENT DAMAGE TO THE TOP RAIL,
IT IS RECOMMENDED TO DRILL A PILOT
HOLE FIRST.

FIG. 3

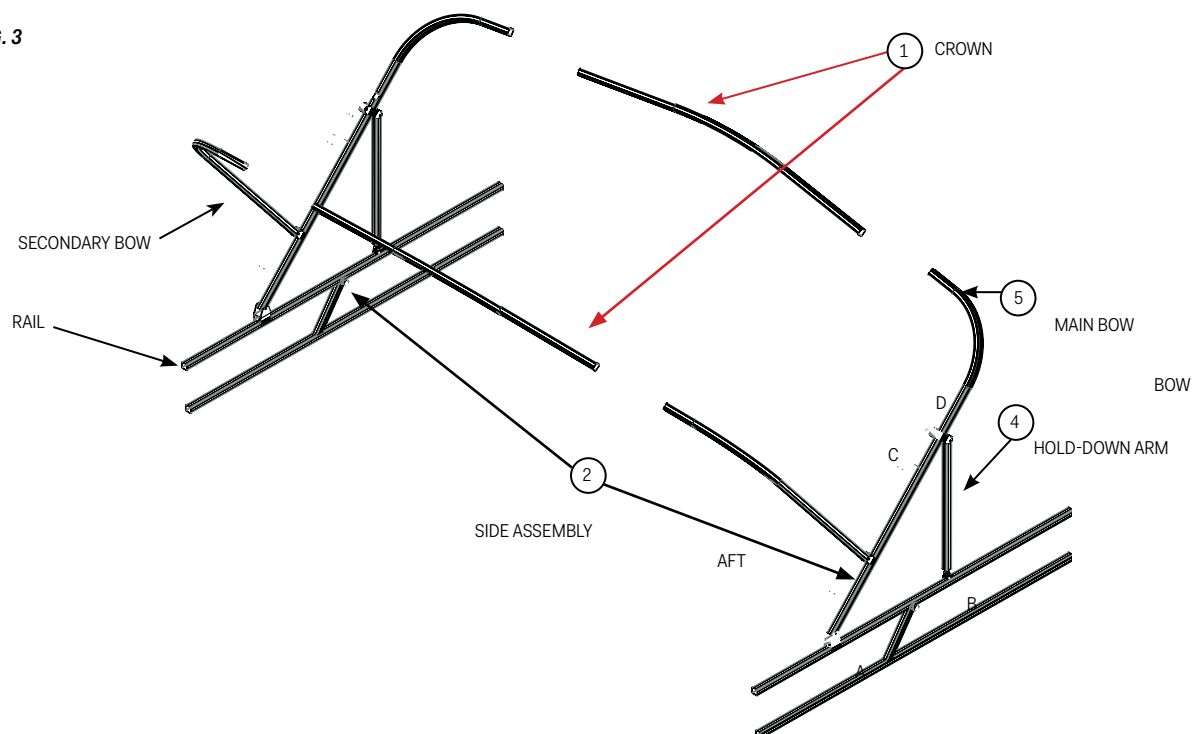

BOW CANOPY & BOW CANOPY FRAME ASSEMBLY (FIGURE 3)

STEP 1

Insert crown pieces (1) into side assemblies (2), making sure that the bend in the center of the mid-frame is to the top and follows the curve of the frame.

STEP 2

After each side assembly has been inserted into each crown piece, secure each split with the provided 1/2" self drilling screws by drilling through the crown into the stakes of the side assemblies

STEP 3

With two people, lift the bow frame assembly onto the boat and insert the main bow tube into the previously installed bow bracket (A). Using barrel nuts and shoulder bolts, two provided 5/16"x2" bolts, lock nuts secure the frame to the rail (Figure 2)

STEP 4

Once the frame is secure, raise the assembly up and latch the hold down arm (4) to the deck button (B)

STEP 5

Lay the secondary bow toward the aft of the boat. Zip the front pocket of the bow canopy to the main bow (5). Release the hold down arms (4) and zip the bow canopy to the aft canopy. Push up the secondary bow up and zip inside pocket.

STEP 6

Center the bow canopy before re-securing the hold down arm (4) to the buttons

FIG. 4

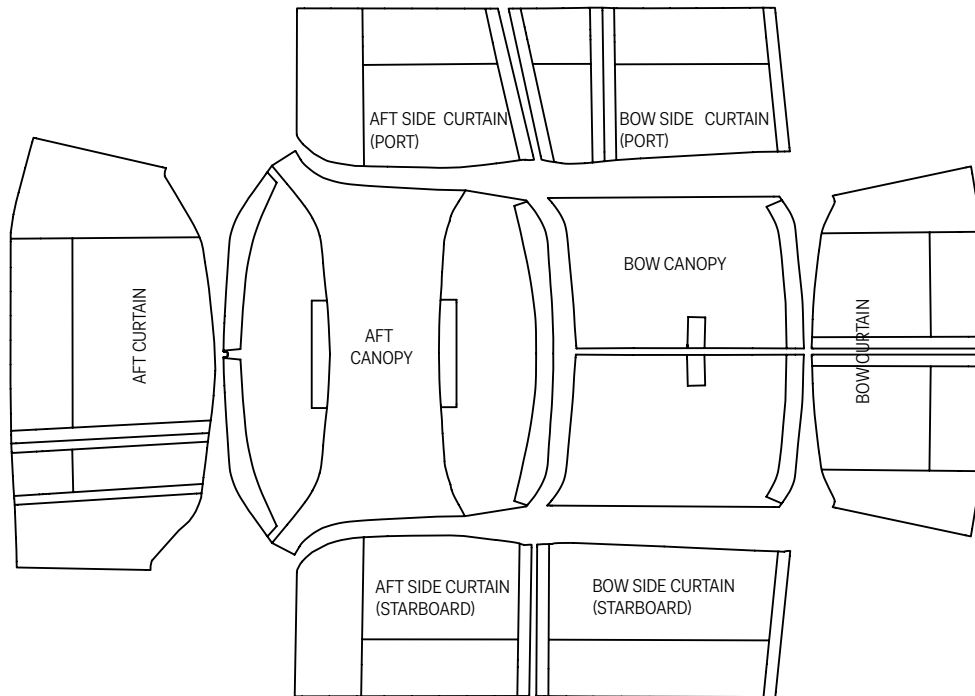

CURTAINS (FIGURE 4)

STEP 1

Each curtain has a tag sewn in the upper left-hand corner of the flap. This will identify each curtain and give its location on the pontoon.

STEP 2

The curtain flaps will face the inside of the pontoon.

STEP 3

Zip all curtains to both canopy tops.

STEP 4

Zip all curtains together.

STEP 5

Zip all curtains together.

STEP 6

Make sure the bottom of the curtains are hanging the same length on both sides of the pontoon. This is where centering both of the canopy tops is very important. If the curtains are uneven, you may have to remove all the curtains and re-center one or both canopy tops.

FIG. 5

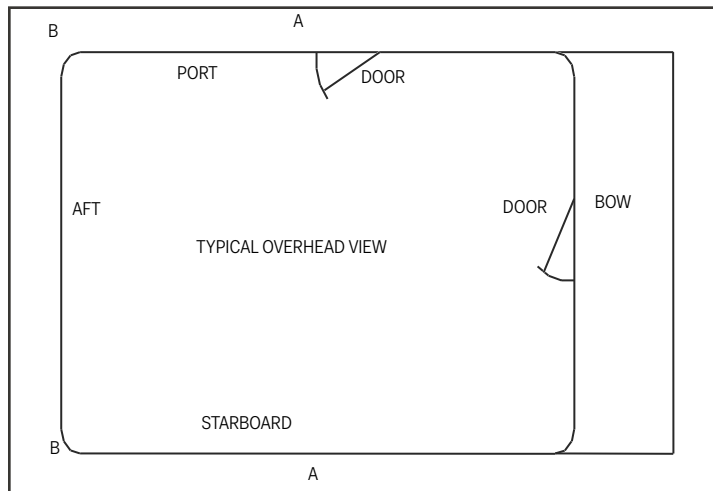

INSTALLING SCREW STUD FASTENERS (FIGURE 5)

STEP 1

Make sure all the curtains are zipped together.

STEP 2

Start with the aft side curtains. Make sure the lower front corner of both curtains hang the same distance from the door opening. Mark the location of the nearest snap (A) on the aluminum rail and install stud.

STEP 3

Find the last snap (B) on the same side. You may have to adjust the curtain bottoms by pulling the curtains taut so they appear smooth along the rail. You do not want the curtains to appear "wavy". Mark and install the stud.

STEP 4

Find the first snap (C) on the same side. Install the remaining studs.

CARE



WARNING

DO NOT TRAILER WITH ANY CANOPY TOP UP (IN RADAR ARCH POSITION) OR WITH THE ENCLOSURE ASSEMBLED!