

INSTALLATION INSTRUCTIONS

2019 Full/Front Enclosure / Double Canopy

Tracker Marine Party Barge 210 DL/DL3 Regency

PARTS LIST

DOUBLE CANOPY

1 Bow Canopy
 1 Bow Canopy Boot
 1 Aft Canopy with Front Zipper
 1 Hardware Package
 1 Bow Frame

FULL ENCLOSURE

1 Aft Canopy with Zippers
 1 Package Screw Studs
 1 Aft Curtain
 1 Bow Canopy with Zippers
 2 Side Side Curtains (1 Port, 1 Starboard)
 2 Bow Side Curtains (1 Port, 1 Starboard)
 1 Bow Curtain
 1 Bow Frame

TOOLS REQUIRED

Measuring Tape
 Center Punch
 Drill
 $\frac{23}{64}$ " Drill Bit
 Pencil
 Phillips Screwdriver
 Wrench



WARNING

INDICATES POTENTIAL HAZARD
 THAT COULD RESULT IN DEATH
 OR INJURY



CAUTION

INDICATES POTENTIAL
 HAZARD THAT COULD
 RESULT IN BOAT DAMAGE



NOTE

INDICATES SPECIAL INFORMATION
 TO MAKE MAINTENANCE EASIER
 OR INSTRUCTIONS CLEARER

NOTE:



This enclosure is designed to fit the 2019 Tracker Marine Regency 210 DL/DL3 Regency Signature Pontoon Boat that has the aft canopy brackets, deck buttons, and eye straps in the following locations:

Main Aft Bracket 70" Rear Aft Button 42" Forward Aft Button 23 ½"

Measurements should be taken from the end of the back of fence for Aft Canopy Brackets and as shown below for bow canopy brackets and buttons in the following locations:

Main to Main 102" Main to Hold-down Arm 23.25"

All measurements are taken to the center of the brackets unless indicated otherwise.

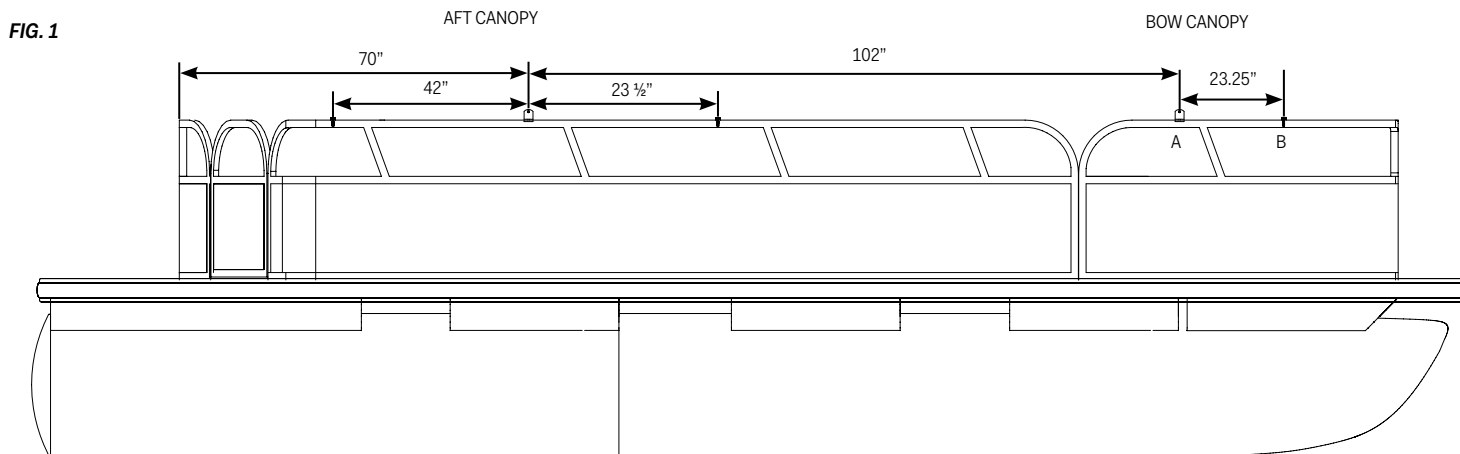

NOTE:



Your pontoon has been pre-assembled with an aft canopy and aft canopy frame from Tracker Marine. The aft canopy that is supplied with the pontoon is not designed to be used with an enclosure. You must remove the standard aft canopy and replace it with the aft canopy that is supplied with the purchase of your enclosure. Once the new canopy is installed, raise the entire unit to the "up" position. Make sure the aft canopy is centered on the frame between the port and starboard sides. This step is very critical, it will determine the final appearance of your completed enclosure.

BRACKET LOCATIONS & ASSEMBLY (FIGURES 1 & 2)

STEP 1

Bracket location (A). Measure and place a mark on the top rail 102" forward from aft main bracket. Bracket location (B). Measure and place a mark on the top rail 23.25" forward from (A).

STEP 2

Center the brackets at each mark as shown in Figure 2. Transfer the centers of each hole at the bottom of the bracket and deck button on to the rail using a center punch.

STEP 3

Using 2³/₆₄" drill bit, drill holes completely through the top rail.

STEP 4

Replace the brackets. Insert (2) bolts from the bottom through the bracket and the rail. Place (2) lock nuts on and tighten (Figure 2).

STEP 5

Install deck buttons at location (B) using barrel nuts.

STEP 6

Follow the same procedure for the other side.

FIG. 2

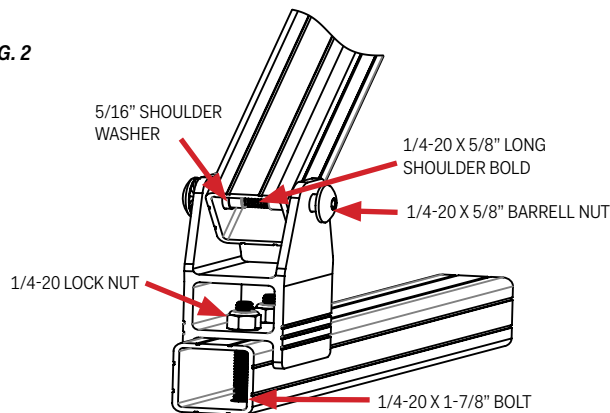

CAUTION

To prevent damage to the top rail, it is recommended to drill a pilot hole first.

FIG. 3

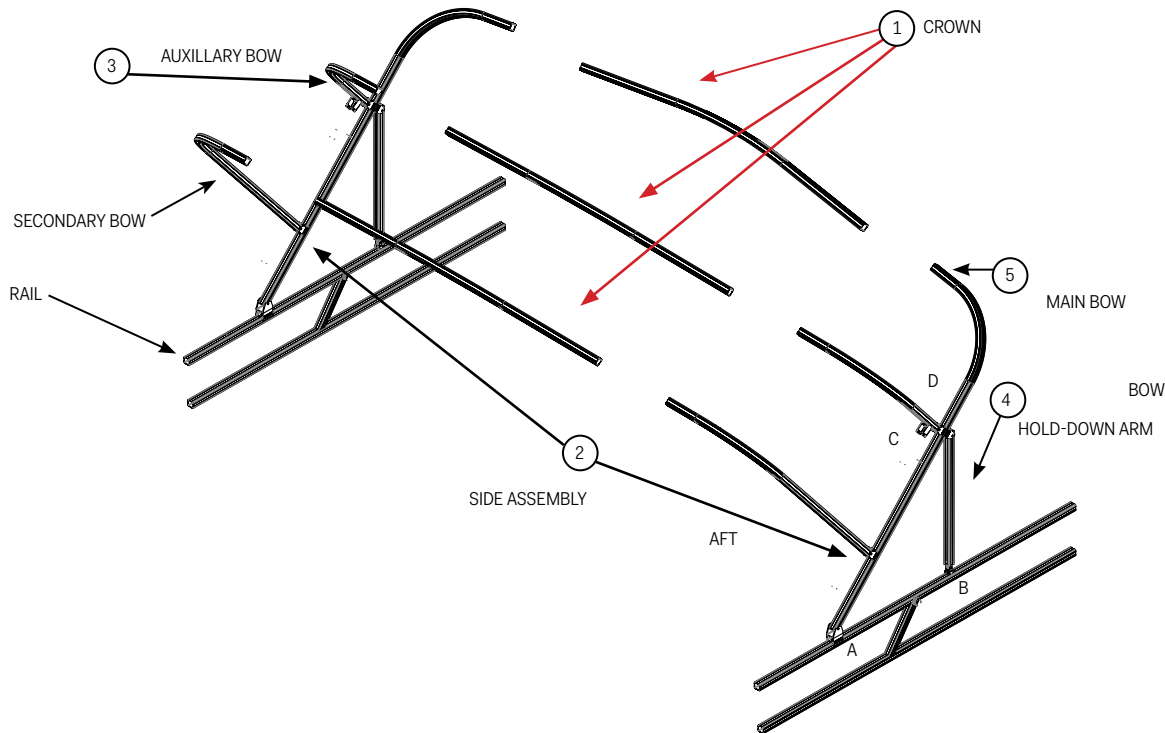

BOW CANOPY & BOW CANOPY FRAME ASSEMBLY (FIGURE 3)

STEP 1

Insert crown pieces (1) into side assemblies (2), making sure that the bend in the center of the mid-frame is to the top and follows the curve of the frame

STEP 2

After each side assembly has been inserted into each crown piece, secure each split with the provided 1/2" self drilling screws by drilling through the crown into the stakes of the side assemblies

STEP 3

With two people, lift the bow frame assembly onto the boat and insert the main bow tube into the previously installed bow bracket (A). Using barrel nuts and shoulder bolts (inserting shoulder washers, see Figure 2), two provided 5/16"x2" bolts, lock washers and tri-wing knobs secure the frame to the rail (Figure 2)

STEP 4

Once the frame is secure, raise the assembly up and latch the hold down arm (4) to the deck button (B)

STEP 5

Lay the secondary and auxiliary bows toward the aft of the boat. Zip the front pocket of the bow canopy to the main bow (5). Release the hold down arms (4) and zip the bow canopy to the aft canopy. Push up the auxiliary bow and zip inside pocket - push the secondary bow up and zip inside pocket.

STEP 6

Center the bow canopy before re-securing the hold down arm (4) to the buttons

FIG. 4

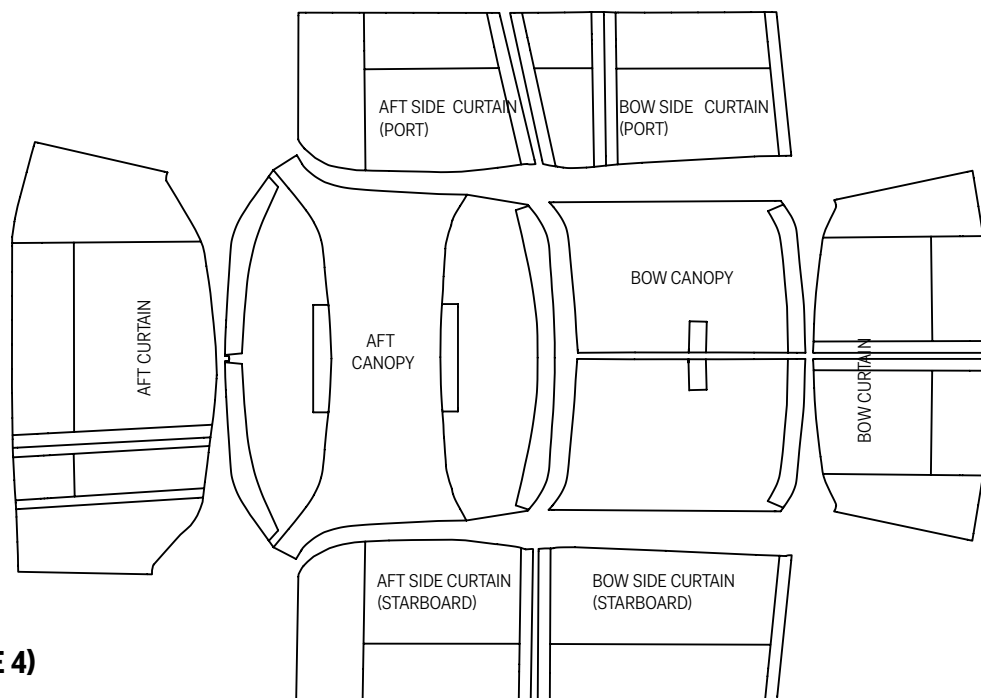

CURTAINS (FIGURE 4)

STEP 1

Each curtain has a tag sewn in the upper left-hand corner of the flap. This will identify each curtain and give its location on the pontoon.

STEP 2

The curtain flaps will face the inside of the pontoon.

STEP 3

Zip all curtains to both canopy tops.

STEP 4

Zip all curtains together.

STEP 5

Leave the bottom of the curtains draped over the pontoon rails.

STEP 6

Make sure the bottom of the curtains are hanging the same length on both sides of the pontoon. This is where centering both of the canopy tops is very important. If the curtains are uneven, you may have to remove all the curtains and re-center one or both canopy tops.

INSTALLING SCREW STUD FASTENERS (FIGURE 5)

STEP 1

Make sure all the curtains are zipped together.

STEP 2

Start with the aft side curtains. Make sure the lower front corner of both curtains hang the same distance from the door opening. Mark the location of the nearest snap (A) on the aluminum rail and install stud.

STEP 3

Find the last snap (B) on the same side. You may have to adjust the curtain bottoms by pulling the curtains taut so they appear smooth along the rail. You do not want the curtains to appear “wavy”. Mark and install the stud.

STEP 4

Find the first snap (C) on the same side. Install the remaining studs.

FIG. 5

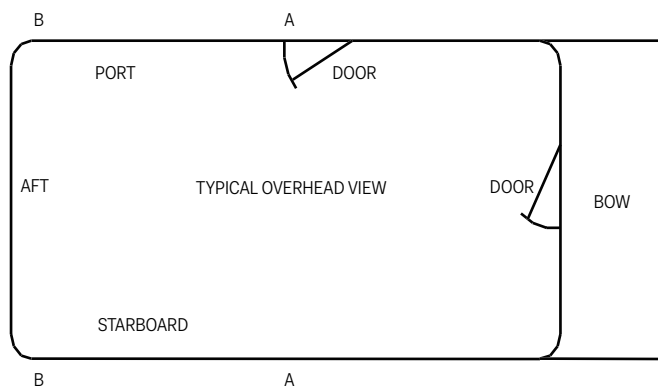

CARE



WARNING

Do not trailer boat with any canopy top up (in radar arch position) or with the enclosure assembled!